



Mailfence

Reclaim your email privacy

A SECURE AND PRIVATE EMAIL

Mohammad Salman Nadeem
Information security analyst – Mailfence
31 March 2017

Why did email encryption never take off?

- Why email data needs to be protected?
- Email encryption was not always secure!
- What is the solution then?
 - **End-to-end encryption!**
- “True” End-to-end encryption is **complicated**
 - it should be made **easy-to-use**

EMAIL ENCRYPTION SHOULD BE MADE EASY

WEB BASED	<ul style="list-style-type: none">• Easy & secure access on all devices
PRIVATE KEY MANAGEMENT	<ul style="list-style-type: none">• Key generation, export, modify and delete their key pair• Generate revocation certificates or perform direct revocation• Import their existing key via file or in-line text• Manage multiple keypairs
PUBLIC KEY SERVER INTEGRATION	<ul style="list-style-type: none">• Seamless integration of key servers in our interface.• Users can publish, search, import, update their public keys• Update public key validation status
INTEGRATED ACCOUNT KEYSTORE	<ul style="list-style-type: none">• Integrated key-store unique to every account• For key-generation / import & advance key management• Supports multiple personal keypair management• Completely independent from any third-party plugin/app

EMAIL ENCRYPTION SHOULD BE SECURE

USE OF STANDARDS	<ul style="list-style-type: none">• Based on OpenPGP standard RFC-4880• Supports both inline and PGP/MIME formats• Completely inter-operable with any other OpenPGP compliant solution
TRUE END-TO-END ENCRYPTION	<ul style="list-style-type: none">• All crypto operations happen on the client side (browser)• Key-generation 4096bit RSA gets generated on the browser, THEN encrypted with the user's passphrase and THEN stored on the server• Server holds a ZERO KNOWLEDGE framework for user keypairs
SUPPORT DIGITAL SIGNATURES	<ul style="list-style-type: none">• Sign, Sign + encrypt• Easy to understand signature validation results
USER-FRIENDLY INTERFACE	<ul style="list-style-type: none">• Crystal interface, which is easy-to-use• Operation flow is as simplified as any other email

EMAIL ENCRYPTION: EMAIL AND MUCH MORE!

Managing emails

- **Calendars:**
Shared calendar, meetings, polls.

- **Groups:**
Manage groups to share data.

- **Documents:**
Create, edit, share documents.

- **Contacts:**
Create, manage and share contacts.

Secure and private email

A UNIQUE ENCRYPTED AND PRIVATE EMAIL

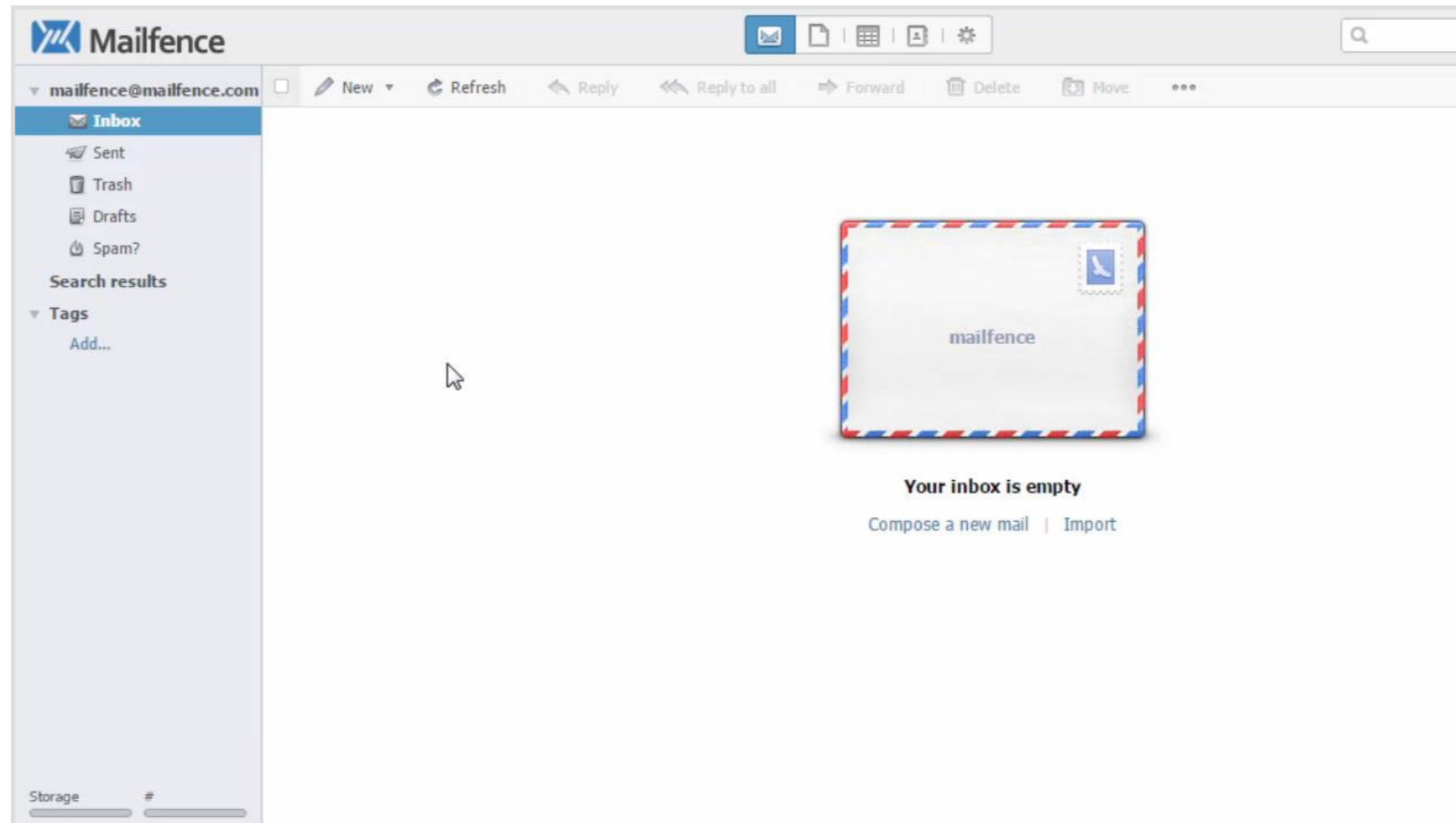

- **Digital Signatures:**
Send & receive digitally signed emails (inline & PGP/MIME).

- **User friendly without plugins or applets**
All is done through the browser

- **E2EE:**
Send & receive encrypted emails (OpenPGP based).
The private key is encrypted with passphrase (AES-256)

Secure and private email

WITH INTEGRATED KEY-SERVER

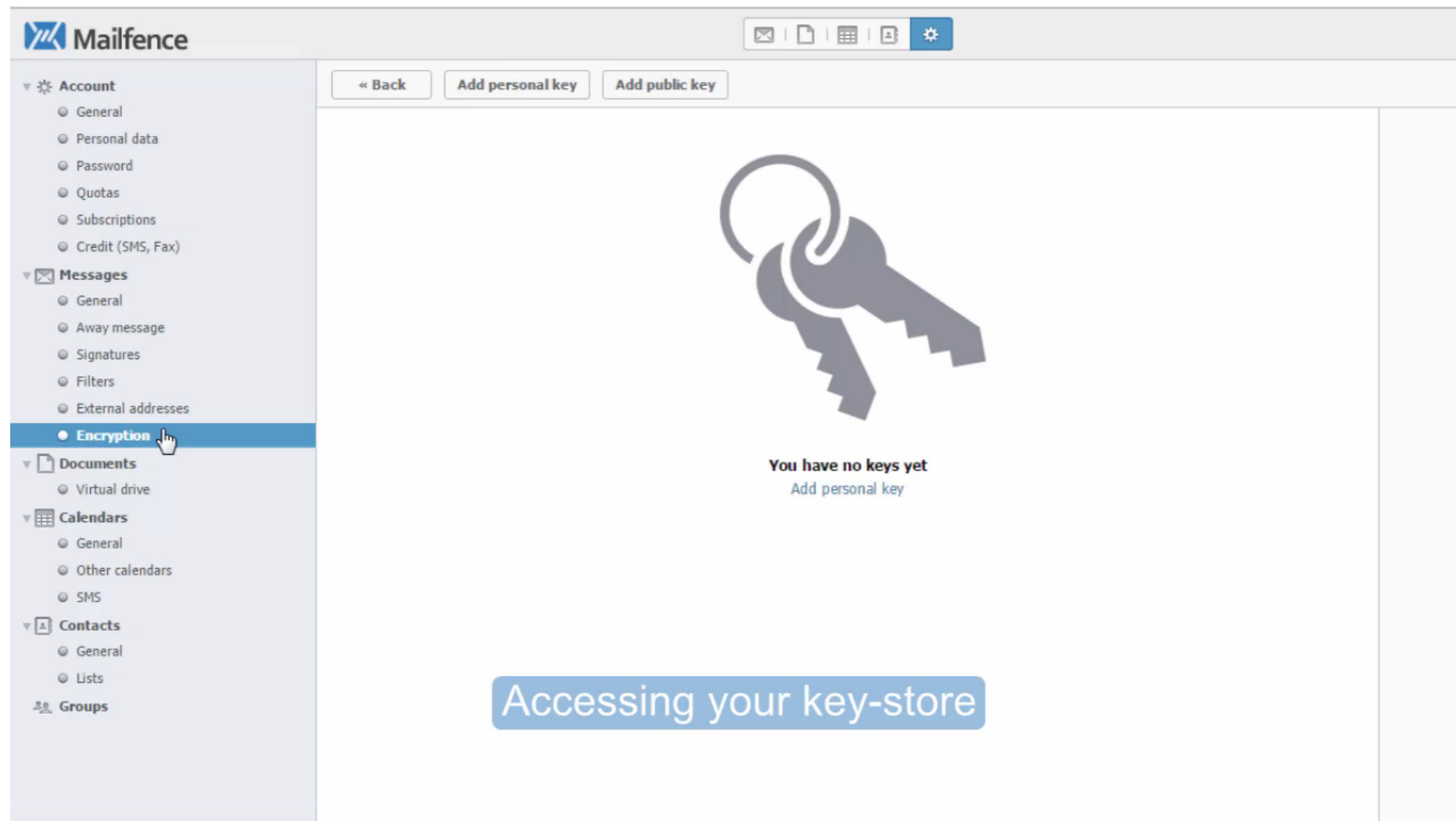

- **Key Management:**
Generate, Import/Export, Modify, Revoke, Delete... your key-pair.

- **Key-server integration**
Queries, Publication, Revocation.

EMAIL ENCRYPTION: USER SHOULD BE FREE

CONTROL OVER YOUR KEYS	<ul style="list-style-type: none">• Users get full control over their OpenPGP keys• No restrictions/or hidden blockages
FULL REVERSIBILITY	<ul style="list-style-type: none">• Users can export their encrypted keypair and other public keys• Users can export their encrypted messages data
NO DIGITAL ISLAND	<ul style="list-style-type: none">• Users can send plain text to any other email address• Users can send encrypted emails other email addresses (OpenPGP interoperability)• Supports encryption/decryption and signing/signature validation of attachments

WITH AN ENTERPRISE OFFERING



	standard	mobility	group
Messages	25 GB	25 GB	25 GB
Documents Privé + groupes	1 GB 1 GB +	1 GB 1 GB +	30 GB 5 GB + 25 GB
Calendriers Contacts	Limité	✓	✓
Groupes Membres/groupe			5 10
Synchro Mobile & web		✓	✓
Support Tél. & email		✓	✓
Voir détails ...		<input type="radio"/> 5.00 €/mois	<input type="radio"/> 25.00 €/mois

- **Personalised version:**
Customised solution to fit specific needs.
Look & feel adaptation
Specific subscriptions

- **API:**
Provisioning, group management,
tool integration

- **Secure authentication:**
Ldap integration, 2FA, SSO, SAML

- **Administration tools:**
Web administration, Owl database
operations, ...

- **Dedicated hosting:**
Both private or public cloud offering



CONTACT US



[Mailfence.com](https://mailfence.com)
[Blog.mailfence.com](https://blog.mailfence.com)
support@mailfence.com